

The background of the slide features a photograph of a tall, brick clock tower with a white top section and a pointed roof, set against a blue sky with scattered white clouds. The tower is surrounded by trees with vibrant autumn foliage in shades of red, orange, and yellow. In the top right corner, the text "OAKLAND UNIVERSITY" is displayed in a large, black, serif font. The "O" in "OAKLAND" is significantly larger than the other letters. Below the main title, the name "Ora Hirsch Pescovitz, M.D." and the date "Monday, October 8, 2018" are written in a smaller, white, sans-serif font with a subtle drop shadow.

OAKLAND
UNIVERSITY™

President's Report to the Board of Trustees

Ora Hirsch Pescovitz, M.D.

Monday, October 8, 2018

FALL 2018 Enrollment

Headcount 19,309

New FTIAC ▲ 9.9%

New Graduate ▲ 3.2%

Total credit hours ▲ 0.7%

Most academically talented
freshman class ever

Average GPA 3.5

Average SAT 1130



Honors College

- Largest entering class ever
 - **>620** students
- Academic excellence
 - \geq **3.7** admission GPA
 - \geq **3.5** graduation GPA
- 2018 FTIACs
 - **3.97** average GPA
 - **4.75** top GPA



FALL 2018 Graduation and Retention

Overall 2017 retention 76.4%

First-year retention

- FTIACs ▲ 0.9%
- Transfers ▲ 2.9%

Graduation Rates*

- 6-year 55%**
- 5-year 49.6%
- 4-year 31.2%
- 6-year (URM) 37.6%



**Figures represent all-time highs for Oakland University*

***Strategic Plan ambitious target rate for 2025 is 55%*



Opening of Hillcrest Hall

- 220,000 square-feet
- 750-beds
- Dining hall
- Meeting spaces
- Classrooms



- Suite-style living
- Kitchenettes
- Laundry facilities
- Study lounges

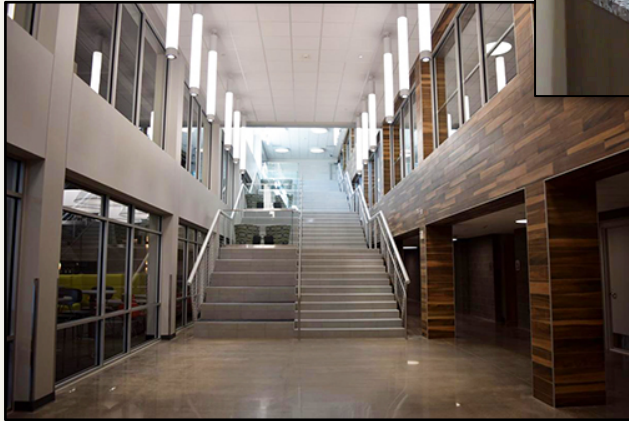

Hillcrest Hall Grand Opening

Friday, October 5, 2018



Oakland Center Expansion

Additional 60,000 square feet

- Founders Ballroom
- The Habitat
- Plum Market Kitchen



- Winter Garden
- Meeting Rooms
- Huddle Rooms
- Reflection Room

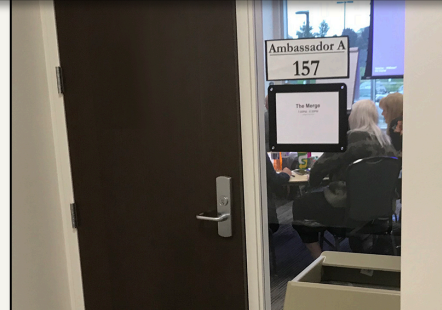

2018 New Student Convocation

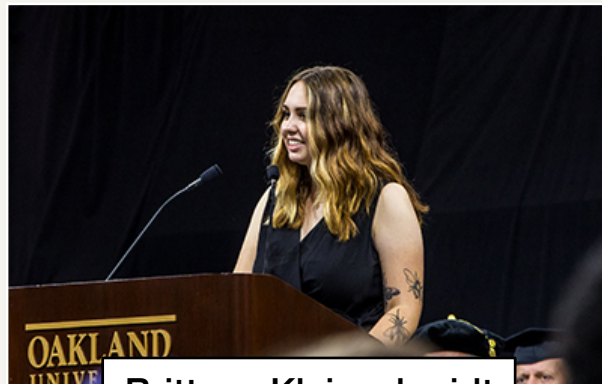

Brittany Kleinschmidt



Justin Jones-Fosu



Attending University of First Choice

- Fall 2012 – **63.1%** of students nationally
- Fall 2017 – **54.4%** of students nationally
- Fall 2012 – **63.6%** of OU students
- Fall 2017 – **66.8%** of OU students

 **8.7 pts**

 **3.2 pts**

***OU is THE
University of Choice***



Dunya Mikhail

Special Lecturer of Arabic

Department of Modern
Languages and Literatures

2018 Guggenheim
Fellowship in Poetry



A photograph of the Oakland University campus during autumn. The central focus is a tall, brick clock tower with a white top section and a pointed roof. The tower is surrounded by trees with vibrant orange and red leaves. In the background, there are modern university buildings and a blue sky with scattered white clouds. The overall scene is bright and colorful.

OAKLAND
UNIVERSITY™

Thank You